

# VersiDrain® 8 Mesh

Dimpled Plastic  
Drain Sheet

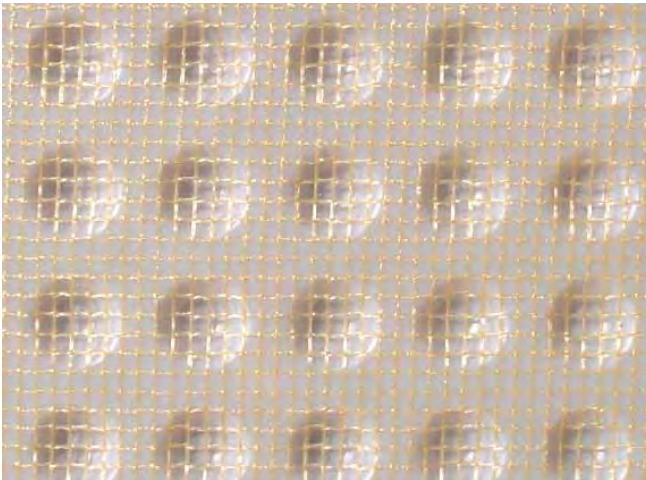

**VersiDrain® 8 Mesh** is a translucent dimpled plastic drain sheet with an integrated plastic mesh that acts as a base for plaster or shotcrete. The dimpled sheet also acts as a seepage layer for internal dampness control of basement walls. The dimples provide an air gap for reliable ventilation between the outer and inner walls.

**VersiDrain® 8 Mesh** functions as an effective vapour barrier and the integrated plastic mesh ensures efficient bonding of the plaster or shotcrete to the dimpled sheet. Plaster boards and timber panels may also be adhered and fastened using proprietary VersiDrain® fixing accessories.

Being translucent, **VersiDrain® 8 Mesh** allows easy alignment and location of the fixing positions.

## Applications

Typical areas of application include:

- Basement walls
- Tunnels
- Underground excavated rock surfaces

## Advantages

- Provides an efficient vapour barrier and ventilation system for underground structures
- Acts as a internal seepage layer for basement walls and tunnels
- Integrated mesh permits plaster or shotcrete thicknesses of up to 25 mm
- Wide and easy to handle rolls result in rapid and low cost installation

1. Shotcrete
2. VersiDrain® Edge Profile
3. **VersiDrain® 8 Mesh**
4. Concrete Slab
5. Rock Surface
6. **VersiDrain® 8**
7. Compacted Gravel
8. Drain Pipe

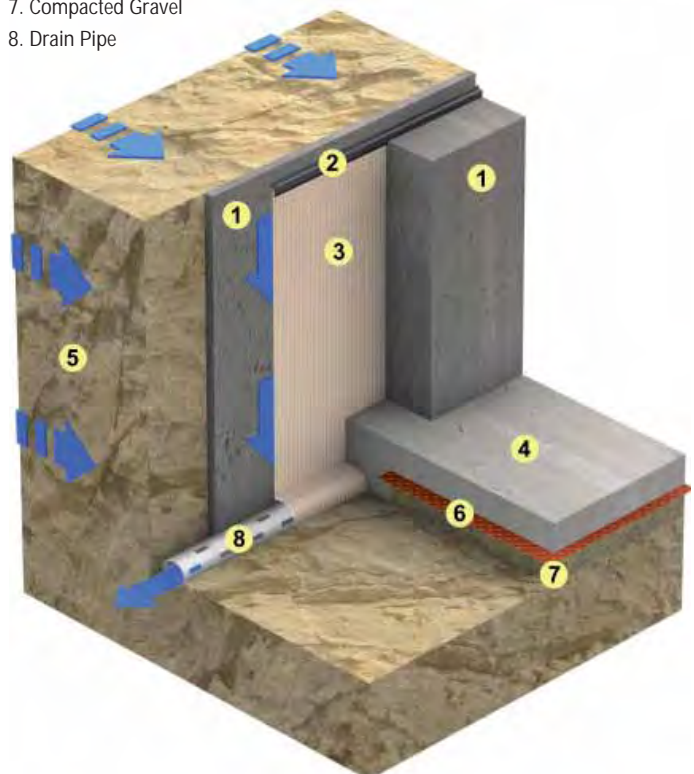

Dampness Control of Basement Walls

## Specifications

---

**Material:** High density polyethylene

---

**Colour:** Translucent white

---

**Weight:** approx. 600 g/m<sup>2</sup>

---

**Sheet thickness:** approx. 0.6 mm

---

**Mesh size:** 500 dtex (warp)  
770 dtex (weft)

---

**Void volume between studs:** approx. 5.5 l/m<sup>2</sup>

---

**Drainage capacity:** approx. 5 l/s.m  
approx. 300 l/min.m  
approx. 18,000 l/h.m

---

**Compressive strength:** approx. 150 kN/m<sup>2</sup> (15 t/m<sup>2</sup>)

---

**Service temperature:** -30°C to 80°C

---

**Biological/chemical resistance:** Resistant to ground chemicals, rot, moulds, algae, bacteria and root penetration. Does not affect potable water.

---

**Fire resistance:** B2 (DIN 4102)

---

VersiDrain® 8 Mesh may be fastened to substrates using proprietary VersiDrain® fixing accessories

VersiDrain® 8 Mesh is manufactured and tested according to DIN 18 195, DIN 4095, DIN 4102, DIN 53 576 and BS 8102.



VersiDrain 8 Mesh provides efficient drainage of tunnels and internal basement walls



**Note:** The information provided in this brochure is based on current knowledge and experience and does not infer any legally binding assurance or warranty, expressed or implied. Intending purchasers should verify whether any changes to specifications or applications or otherwise have been made since this literature was issued.

Singapore Office: +65 6356 2800  
Australia Office: +61 2 9648 2073

[www.elmich.com](http://www.elmich.com)

Distributed by:

KEN HITCHCOCK DESIGNS P/L  
1279 MALVERN ROAD  
MALVERN VIC 3144  
TEL: 03 9822 2748  
FAX: 03 9822 3748  
EMAIL: [khitchcock@ozemail.com.au](mailto:khitchcock@ozemail.com.au)  
[www.stonemerchants.com.au](http://www.stonemerchants.com.au)